

Features & Benefits

- Attractive Appearance
- Lower Installation Cost
- Lower Carbon Footprint
- No Power Outages
- Easy to Convert to Solar
- 450Lm-500Lm
- Chameleon CCT™ 3000K & 4000K
- Turtle-Friendly Amber Available
- One Touch Selector Button
- Battery ON/OFF Function Button
- Battery Level LED Display
- Coretemp™ Battery Anti Freeze Technology



10 Year Available
15 Year Available



Exclusive Free
Battery Recycling
Program



Stainless Steel
In-Ground
Anchor with
Hinged Lockable
Cover Available

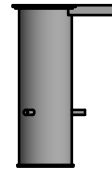

Certifications



Specifications	
Wattage	2.5 Watts LED
Battery	7.4V 10 AH
Solar Panel	Impact Resistant Monocrystalline 8W
Working Temperature	-40 °F - +140 °F
Material	Aluminum
CCT	Standard - 3000K & 4000K/ Others Available
Lifetime	50,000 Hours
Autonomy	2-3 Rainy Days
Height	24"/36"/42" Other Heights Available
Lumens	450Lm-500Lm
Option	PTC Auto heat system ideal for use in cold & snowy climates
Temperature with PTC Warmer	Charge Temperature -40°F to +140°F Discharge Temperature -40°F to +140°F
Temperature Without PTC Warmer	Charge Temperature 14°F to +140°F Discharge Temperature -4°F to +140°F

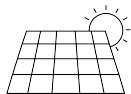

Monocrystalline
Solar Module

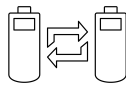

10AH
Batteries

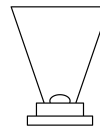

Cree Cob
LED Chip



IP65



AMERICAN COMBAT VETERAN OWNED COMPANY



405-673-8684

www.gridshiftsolar.lighting

Corporate: 2803 Broadway Ct. Edmond, OK 73013
California: 1341 Distribution Way, Suite 20, Vista, CA 92081

Cuesta Sol is a trademark of GridShift Solutions, LLP



Lighting Profiles

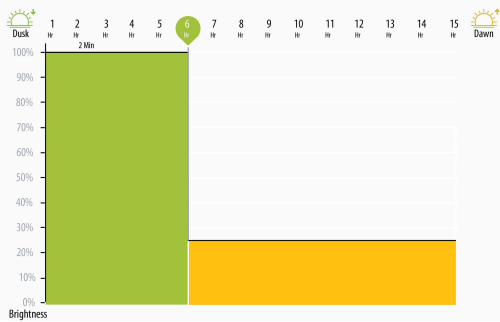

Profile 1
(Turn on/One Flash)
6H 100% Brightness, then 25% to dawn.

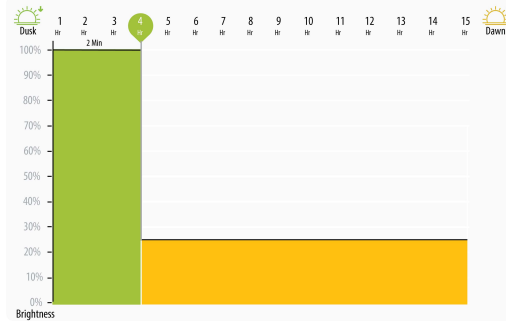

Profile 2
(One Push/Two Flashes)
4H 100% Brightness, then 25% to dawn.

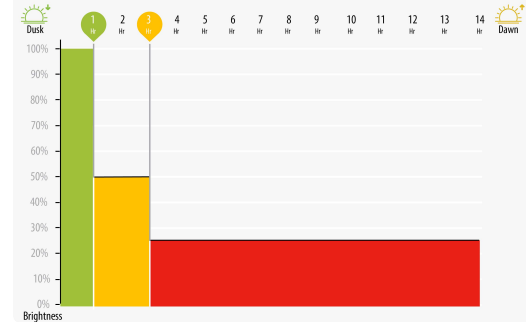

Profile 3
(One Push/Three Flashes)
1H 100% Brightness, 2H at 50%, then 25% to dawn.

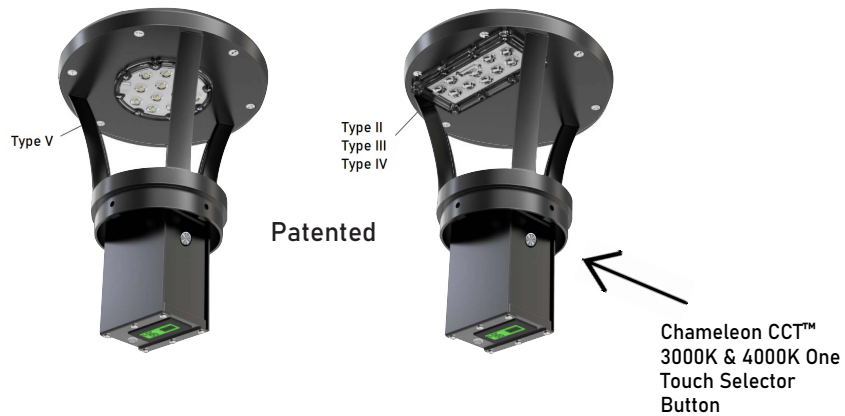

AMERICAN COMBAT VETERAN OWNED COMPANY



405-673-8684

www.gridshiftsolar.lighting

Corporate: 2803 Broadway Ct. Edmond, OK 73013
California: 1341 Distribution Way, Suite 20, Vista, CA 92081

Cuesta Sol is a trademark of GridShift Solutions, LLP

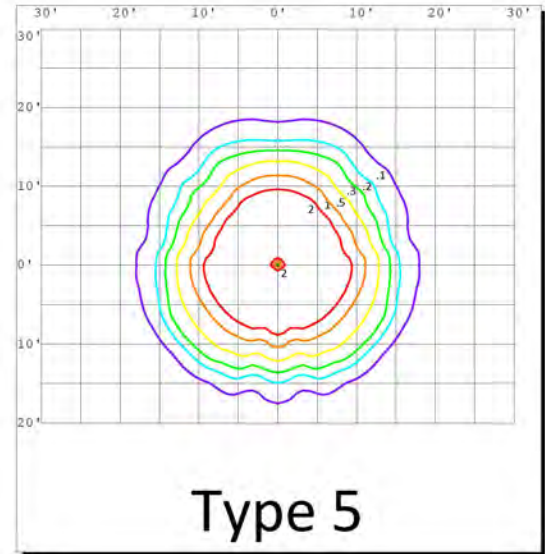
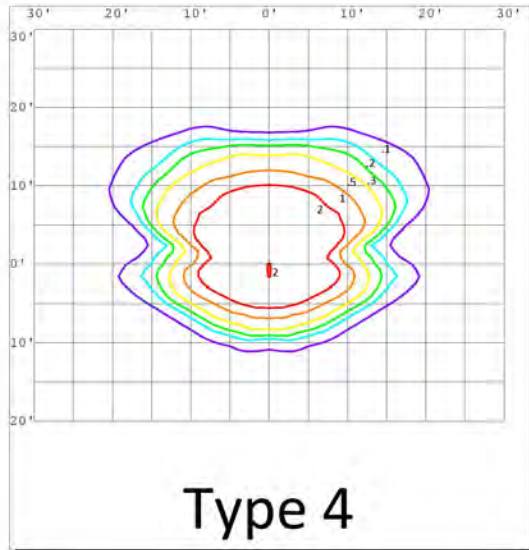

Photometrics

Model #	Available Optic Types	Fixture Profile Codes	Height	Option	Option
Cuesta Sol CS-BOL-SEN-6R	II / IV / V (Type III available, please consult Sales Associate.)	(See Profile Codes)	24" / 36" / 42" / Custom	PTC Auto Heat System	Stainless steel in-ground anchor with hinged lockable cover

Ordering Description Example					
Cuesta Sol CS-BOL-SEN-6R	II	Profile 2	36"	PTC	GA

Ordering Description					
Cuesta Sol CS-BOL-SEN-6R					

AMERICAN COMBAT VETERAN OWNED COMPANY

 405-673-8684
www.gridshiftsolar.lighting

 Corporate: 2803 Broadway Ct. Edmond, OK 73013
 California: 1341 Distribution Way, Suite 20, Vista, CA 92081

Cuesta Sol is a trademark of GridShift Solutions, LLP

